

## STANDARD Q

# HIV/Syphilis Combo



STANDARD Q HIV/Syphilis Combo performs qualitative analysis by detecting antibodies specific to HIV-1, HIV-2 and Syphilis (*Treponema pallidum*) in serum, plasma and whole blood using immunochromatography. With a simple test method, HIV and/or syphilis infection status can be discriminated, and with its high sensitivity and specificity, the screening test result can be obtained within 15 minutes.

### GENERAL INFORMATION:

- Simultaneous detection of HIV-1/2 and Syphilis in one test
- Easy to use, Easy to read and interpret
- Discrimination between HIV-1 and HIV-2 antibodies
- Room temperature storage



Specification	
Specimen	Serum/Plasma/Whole Blood
Test Time	15 mins. (Do not read after 20 mins.)
Specimen Volume	Whole Blood: 20µl, Serum/Plasma: 10µl
Storage Temperature	2-40°C / 36-104°F

### TEST PROCEDURE

#### Whole blood

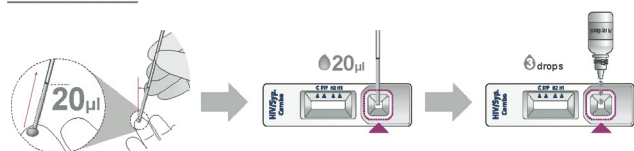

#### Serum / Plasma

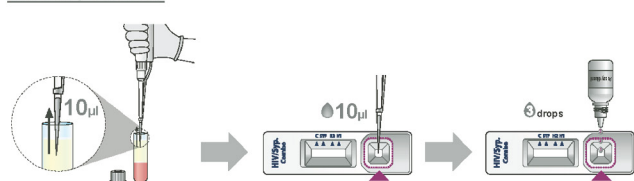

### TEST PERFORMANCE (In accordance with CTS)

#### Detection of HIV / Syphilis

Sensitivity [95% CI]		Specificity [95% CI]	
Total	100% [99.4-100%] (637/637)	Total	100% [99.6-100%] (1,898/1,900)
HIV-1 positive	100% (497/497)	EDTA plasma	100% (1,000/1,000)
HIV-1 positive (non-B subtypes)	100% (40/40)	Whole Blood	99.8% (499/500)
HIV-2 positive	100% (100/100)	Hospitalized patients	99.5% (199/200)
		Pregnant Woman	100% (200/200)

\* non-B subtypes: A, A1, CRF01\_AE, CRF02\_AG, CRF06\_cpx, CRF36\_cpx, D, F1, F2, G, H, J, K, Group O

### TEST PERFORMANCE (In accordance with CTS)

#### Detection of *Treponema pallidum* Ab

Sensitivity [95% CI]		Specificity [95% CI]	
Total	98.8% [97.1-99.5%] (395/400)	Total	100% [99.8-100%] (1,900/1,900)
Tp & HIV positive	100% (497/497)	EDTA plasma	100% (1,000/1,000)
Tp positive	100% (40/40)	Whole Blood	100% (500/500)
		Hospitalized patients	100% (200/200)
		Whole Blood	100% (500/500)
		Hospitalized patients	100% (200/200)

### ORDERING INFORMATION

Category	Product	Pack Size
Blood Borne Disease	STANDARD Q HIV/Syphilis Combo Test	25 Test