



J. Mitra & Co. Pvt. Ltd.

.....a vision to serve mankind™



Scrub typhus spreads through bites of infected mites

For the most Reliable Diagnosis of Scrub Typhus



SCRUB TYPHUS IgM/IgG/IgA CARD

RAPID TEST

Rapid, visual test for the qualitative detection of IgM/IgG/IgA antibodies to Scrub Typhus (Tsetugamushi) in Human Serum / Plasma/ Whole Blood.



SCRUB TYPHUS (TSUTSUGAMUSHI) IgM & IgG CARD

Rapid Visual test for the Differential Detection of IgM & IgG antibodies to Scrub Typhus in Human Serum/ Plasma



SCRUB TYPHUS IgM Quanti CARD

Fluorescence immunoassay (FIA) TEST

Fluorescence immunoassay for qualitative detection of Scrub Typhus IgM antibodies in Human Serum/ Plasma



SCRUB TYPHUS IgM MICROLISA ELISA TEST

Microwell ELISA Test for the Detection of Scrub Typhus IgM Antibodies in Human Serum/ Plasma

**...precision &
Accuracy, Guaranteed**

Know about Scrub Typhus Disease

Scrub typhus is a mite-borne infectious or zoonotic infection, a disease caused by a bacteria called *Orientia tsutsugamushi* and the infection is found in South East Asia and western Pacific islands. The causative organism, *orientia tsutsugamushi*, belongs to family Rickettsiaceae is transmitted to humans by the bite of a larval trombiculid mite or chigger. The most common symptoms of scrub typhus include fever, headache, body aches, swollen lymph glands, rash and an eschar at the site of the chigger bite. In the Indian scenario, there is a higher case fatality of 14% when presenting with complications.



Health problems related with Scrub Typhus are Interstitial pneumonia leading to ARDS (Acute Respiratory Distress Syndrome), Renal failure, Septic shock, Jaundice, Meningoencephalitis and Myocarditis .

Diagnosis of Scrub Typhus Disease

The diagnosis is suggested by the clinical history and physical findings and confirmed by PCR, LAMP, biopsy of an eschar or serologic testing. Immuno-based Serological methods like IFA, ICT and ELISA are most outrank for detection of scrub typhus due to their higher sensitivity and specificity.

SCRUB TYPHUS IgM QUANTI CARD

Fluorescence based Immunoassay for qualitative measurement of scrub typhus IgM antibodies in human plasma/ Plasma

- **Principle: Based on most advanced fluorescence immunoassay**
- **QR Code on each cartridge includes lot specific data, no chip required**
- **Individually pouched test cartridge**
- **Sensitivity: 100% & Specificity: 100%**
- **Results within 20 Minutes**
- **Long Shelf Life: 15 Months At 2-8°C**
- **Convenient pack size: 25 tests**



Test Procedure

Step-1

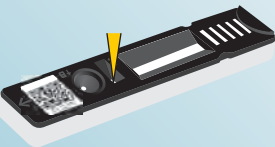

Add 10µl of serum/ plasma using micropipette to the sample well of the Cartridge

Step-2

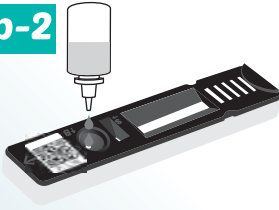

Add 2 drops of assay buffer in the buffer well of the test cartridge and leave the cartridge for 20 minutes at RT (20-30°C)

Step-3

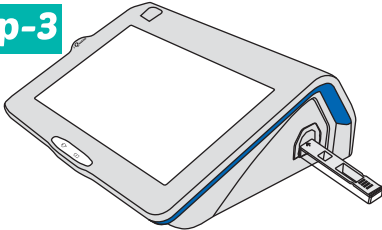

Place test cartridge in the Analyzer and Read Result.*



- **Based on “Indirect ELISA”**
- **Excellent Sensitivity: 100% & Specificity: 98.58%**
- **Ready to use Enzyme Conjugate**
- **Unique Break-away wells provided in 24 tests pack for user convenience**
- **Assay Procedure: 75 minutes**
- **Shelf Life : 24 Months at 2-8°C**
- **Colour Coded reagents to monitor procedural steps**

SCRUB TYPHUS IgM MICROLISA

Microwell ELISA Test for the Detection of Scrub Typhus IgM Antibodies in Human Serum/ Plasma

TEST PROCEDURE

Dilute Sample (1:101) sample 5 µl + sample diluent 500 µl	
Add 100 µl diluted samples & Ready to use controls	
Cover the plate & incubate for 30 minutes at 37°C	
Wash 5 Cycles	
Add 100 µl Enzyme Conjugate	
Cover the plate & incubate for 30 minutes at 37°C	
Wash 5 Cycles	
Prepare Working Substrate	No. of strip TMB 1 2 3 4 5 6 7 8 9 10 11 12 Substrate (ml). 0.5 1.0 1.5 2.0 2.5 3.0 3.5 4.0 4.5 5.0 5.5 6.0 TMB Diluent (ml). 0.5 1.0 1.5 2.0 2.5 3.0 3.5 4.0 4.5 5.0 5.5 6.0
Add 100 µl working Substrate	
Cover the plate & incubate for 15 minutes at Room Temperature	
Add 100 µl Stop Solution and Read Results 450 nm /630 nm	

TEST PRINCIPLE

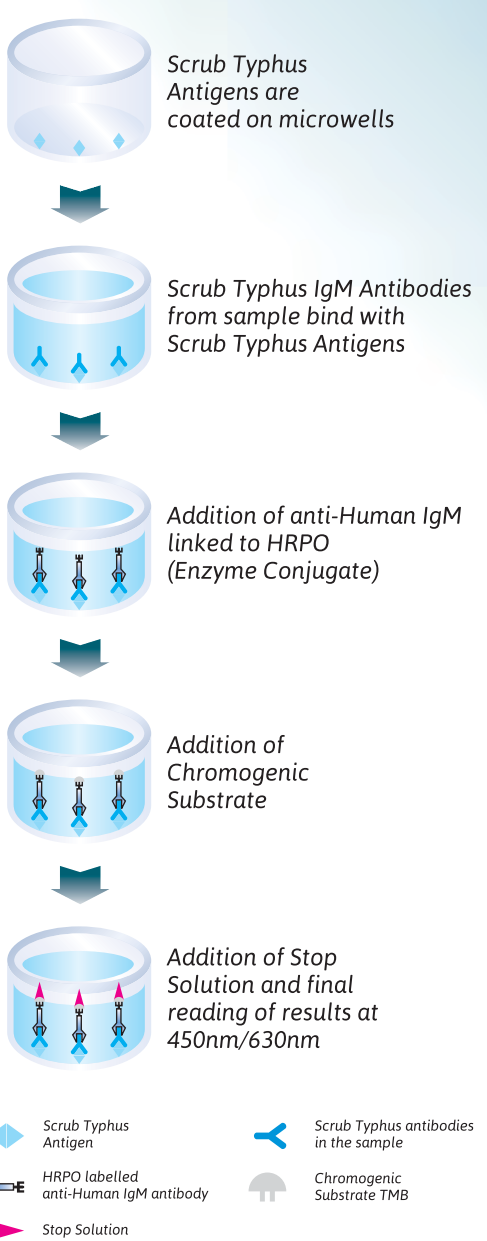

SCRUB TYPHUS (TSUTSUGAMUSHI) IgM & IgG CARD

Rapid Visual test for the Differential Detection of
IgM & IgG antibodies to Scrub Typhus in Human Serum/ Plasma



- **Excellent Sensitivity: 100% & Specificity: 100%**
- **Long Shelf life: 30 Months at 2-30°C**
- **Results within 20 minutes**

TEST PROCEDURE

Step-1

Add 10 µl specimen using Sample Dropper to the sample well "S" of the device.



Step-2

Add 2 drops (70 µl) of Assay Buffer to the Buffer well "B" of the device.

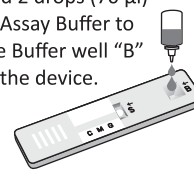

Step-3

Read results at 20 minutes



Do not read results after 30 minutes

Available Packsize: 20 Tests & 50 Tests

RESULT INTERPRETATION

**Reactive for Scrub Typhus
IgM & IgG antibodies**



**Non-Reactive for
Scrub Typhus antibodies**



**Reactive for
Scrub Typhus IgM antibodies**



Invalid



**Reactive for
Scrub Typhus IgG antibodies**



Invalid



If no control line 'C' appears after the completion of test, the test should be treated as Invalid. Repeat the test using new device.

SCRUB TYPHUS IgM/IgG/IgA CARD

Rapid, visual test for the qualitative detection of IgM/IgG/IgA
antibodies to Scrub Typhus (Tsutsugamushi) in Human Serum / Plasma/ Whole Blood.



Available Packsize: 25 Tests

- **Finger prick quick visual rapid test**
- **Ideal test for physician's clinic & Nursing homes for immediate results**
- **Excellent Sensitivity: 100% & Specificity: 100%**
- **Long Shelf life: 30 Months at 2-30°C**

TEST PROCEDURE

Step-1

Add 10 µl specimen using Sample Dropper to the sample well of the device.

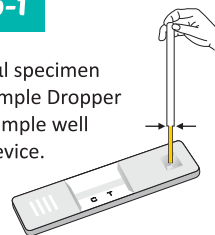

Step-2

Add 1 drop (35 µl) of Assay Buffer to the sample well of the device.

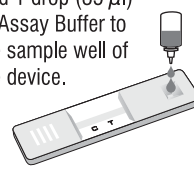

Step-3

Read results at 20 minutes



Do not read results after 30 minutes

RESULT INTERPRETATION

REACTIVE for scrub typhus antibodies



NON-REACTIVE for scrub typhus antibodies



INVALID



If no control line 'C' appears after the completion of test, the test should be treated as Invalid. Repeat the test using new device.